

2

1

PART NUMBER	A
LMDT-P20-7.2BS	7.19 [182.6]
LMDT-P20-9.6BS	9.59 [243.6]
LMDT-P20-12.0BS	11.99 [304.5]
LMDT-P20-14.4BS	14.39 [365.5]
LMDT-P20-16.8BS	16.79 [426.5]
LMDT-P20-19.2BS	19.19 [487.4]
LMDT-P20-21.6BS	21.59 [548.4]
LMDT-P20-24.0BS	23.99 [609.3]
LMDT-P20-26.4BS	26.39 [670.3]
LMDT-P20-28.8BS	28.79 [731.3]
LMDT-P20-31.2BS	31.19 [792.2]
LMDT-P20-33.6BS	33.59 [853.2]
LMDT-P20-36.0BS	35.99 [914.1]
LMDT-P20-38.4BS	38.39 [975.1]
LMDT-P20-40.8BS	40.79 [1036.1]
LMDT-P20-45.6BS	45.59 [1158.0]
LMDT-P20-48.0BS	47.99 [1218.9]

REVISION HISTORY						
REV	ECO#	ZONE	DESCRIPTION	BY	DATE	APPROVED
A	-	-	INITIAL RELEASE	JAW	4/14/2004	DJC
B	159	-	CHANGES PER ECO# 159	JAW	9/27/2004	DJC
C	188	-	CHANGER PER ECO# 188	PMJ	11/3/2005	JAW

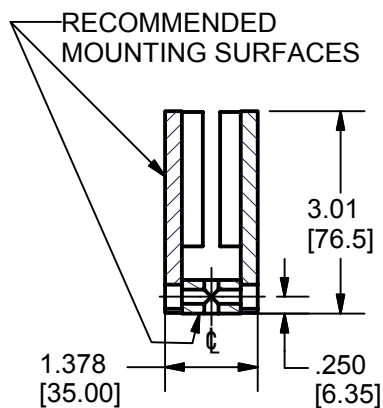

SECTION A-A

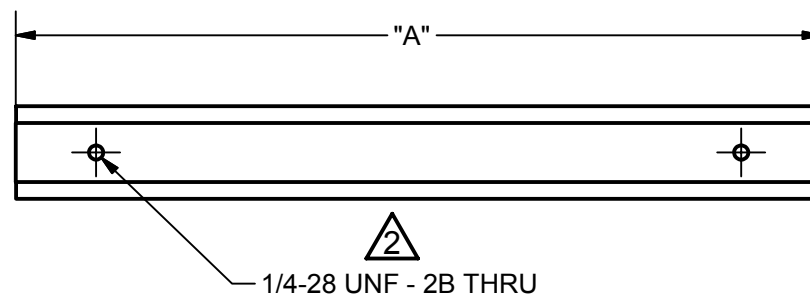
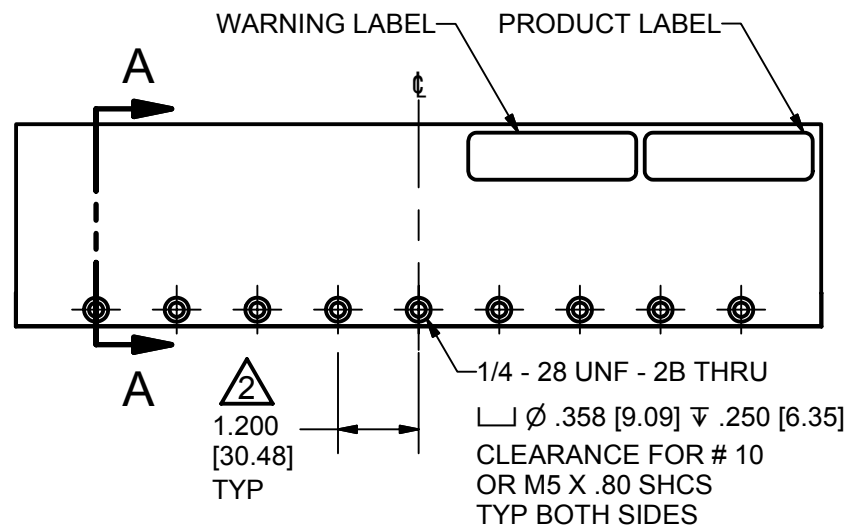

NOTES:

- INCHES [MILLIMETERS].
- CONSULT FACTORY FOR DETAILED DRAWINGS OF BOTTOM AND SIDE MOUNT OPTIONS. CENTERLINE MAY HAVE A FASTENER OR MOUNTING HOLE DEPENDING ON TRACK LENGTH.
- REFER TO DRAWING 11046 FOR PART NUMBERING CONVENTION.
- TRACK SECTIONS CAN BE CASCADED TO FORM ANY LENGTH. 1.20 [30.5] HOLE SPACING AND MOUNTING SURFACES MUST BE MAINTAINED.
- LMDT-P20-12.0BS TRACK SHOWN.

UNLESS OTHERWISE SPECIFIED:
 - DIMENSIONS ARE IN INCHES [mm]
 - TOLERANCES ON:
 X.XX ± 0.01 [± 0.25 mm]
 X.XXX ± 0.005 [± 0.125 mm]
 X/X ± 1/32
 ANGLES ± 0°30' 
 DRAWING CONFORMS TO ANSI Y14.5

THESE DRAWINGS AND SPECIFICATIONS ARE THE PROPERTY OF AIREX CORP. ARE PROPRIETARY, ISSUED IN STRICT CONFIDENCE, AND SHALL NOT BE REPRODUCED, CONVEYED OR USED WITHOUT PRIOR WRITTEN PERMISSION.

DRAWN	DATE
John W	4/13/2004
CHECKED	DATE
PMJ	12/16/2005
APPROVED	DATE
JAW	12/16/2005
RELEASED	DATE
PMJ	12/16/2005
SCALE	SHEET
NTS	3 OF 3

AIREX CORPORATION
 Precision Electromagnetic Component Design and Manufacturing
 www.airex.com

TITLE
 P20 SERIES TABULATED SPECIFICATION DRAWING - MAGNET TRACK

SIZE	PART NO	REV
A	11053	C

NEXT LEVEL ASSEMBLY

2

1