

PART NUMBER	A
LMDT-P15-7.2FS	7.19 [182.6]
LMDT-P15-8.4FS	8.39 [213.1]
LMDT-P15-9.6FS	9.59 [243.6]
LMDT-P15-10.8FS	10.79 [274.1]
LMDT-P15-12.0FS	11.99 [304.5]
LMDT-P15-13.2FS	13.19 [335.0]
LMDT-P15-14.4FS	14.39 [365.5]
LMDT-P15-15.6FS	15.59 [396.0]
LMDT-P15-16.8FS	16.79 [426.5]
LMDT-P15-18.0FS	17.99 [456.9]
LMDT-P15-19.2FS	19.19 [487.4]
LMDT-P15-20.4FS	20.39 [517.9]
LMDT-P15-21.6FS	21.59 [548.4]
LMDT-P15-22.8FS	22.79 [578.9]
LMDT-P15-24.0FS	23.99 [609.3]

REVISION HISTORY						
REV	ECO#	ZONE	DESCRIPTION	BY	DATE	APPROVED
A	-	-	INITIAL RELEASE	JAW	4/13/2004	DJC
B	159	-	CHANGES PER ECO 159	JAW	9/27/2004	DJC
C	188	-	CHANGES PER ECO# 188	PMJ	12/16/2005	PMJ

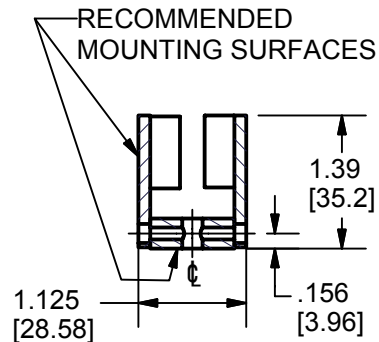

SECTION A-A

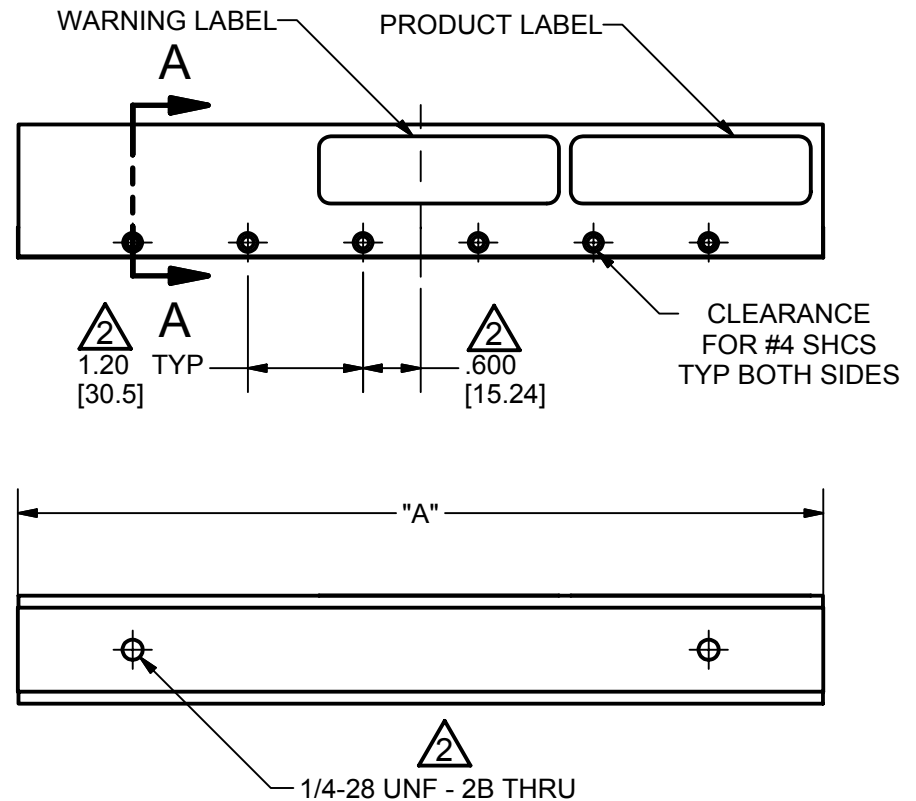

NOTES:

1. INCHES [MILLIMETERS].
- △ CONSULT FACTORY FOR DETAILED DRAWINGS OF BOTTOM AND SIDE MOUNT OPTIONS. CENTERLINE MAY HAVE A FASTENER OR MOUNTING HOLE DEPENDING ON THE TRACK LENGTH.
3. REFER TO DRAWING 11046 FOR PART NUMBERING CONVENTION.
4. TRACK SECTIONS CAN BE CASCADED TO FORM ANY LENGTH. 1.20 [30.5] HOLE SPACING AND MOUNTING SURFACES MUST BE MAINTAINED.
5. LMDT-P15-8.4FS TRACK SHOWN.
6. CONSULT FACTORY FOR TRACK LENGTHS GREATER THAN 24" [609.6].

UNLESS OTHERWISE SPECIFIED:  
 - DIMENSIONS ARE IN INCHES [mm]  
 - TOLERANCES ON:  
 X.XX ± 0.01 [± 0.25 mm]  
 X.XXX ± 0.005 [± 0.125 mm]  
 X/X ± 1/32  
 ANGLES ± 0°30'   
 DRAWING CONFORMS TO ANSI Y14.5

THESE DRAWINGS AND SPECIFICATIONS ARE THE PROPERTY OF AIREX CORP. ARE PROPRIETARY, ISSUED IN STRICT CONFIDENCE, AND SHALL NOT BE REPRODUCED, CONVEYED OR USED WITHOUT PRIOR WRITTEN PERMISSION.

DRAWN	John W	DATE	4/12/2004
CHECKED	PMJ	DATE	12/16/2005
APPROVED	JAW	DATE	12/16/2005
RELEASED	PMJ	DATE	12/16/2005
SCALE	NTS	SHEET	3 OF 3
MATERIAL	N/A	SIZE	A
FINISH	N/A	PART NO	11052
		REV	C

**AIREX CORPORATION**  
 Precision Electromagnetic Component Design and Manufacturing  
 www.airex.com

TITLE: P15 SERIES TABULATED SPECIFICATION DRAWING - MAGNET TRACK

NEXT LEVEL ASSEMBLY